

# VTM97A

## 0-ch Inclined Bracket



### Series Overview

The VTO bracket features a unique design that enables the angle to be easily adjusted for optimal positioning of the VTO.

### Technical Specification

#### Basic

Surface Treatment	powder spraying
Product Type	Wall mount bracket
Casing Material	SPCC
Horizontal Rotation Angle	22.5°–45°

#### General

Appearance Color	Black
Product Dimensions	134.0 mm × 71.2 mm × 44.0 mm (5.28" × 2.80" × 1.73")
Packaging Dimensions	184.0 mm × 135.0 mm × 89.0 mm (7.24" × 5.31" × 3.50")
Transport Package Dimensions	478.0 mm × 288.0 mm × 204.0 mm (18.82" × 11.34" × 8.03")
Operating Temperature	−40 °C to +60 °C (−40 °F to +140 °F)
Operating Environment	Outdoor
Net Weight	0.32 kg (0.71 lb)
Gross Weight	0.42 kg (0.93 lb)
Installation	Wall Mount
Applicable Product Model	DHI-VTO2111D-P-S3
Storage Temperature	−10 °C to +70 °C (14 °F to +158 °F)
Storage Humidity	10%-90% (RH)

### Ordering Information

Type	Model	Description
Inclined Bracket	VTM97A	0-ch Inclined Bracket

### Installation

#### 1.1

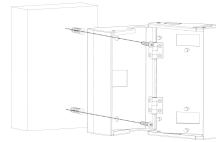

#### 1.2

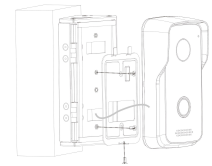

#### 1.3



#### 1.4

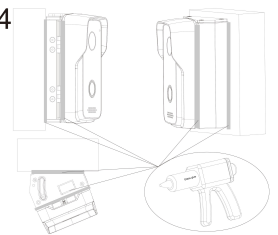

### Dimensions (mm[inch])

